

ART TOUR MAP

FOR MORE DETAILS & DIRECTIONS VISIT
ART35N.ORG

-  = MAKE & TAKE DEMONSTRATIONS
-  = NO MAKE & TAKE DEMONSTRATIONS
-  = MORE THAN ONE ARTIST AT THIS LOCATION

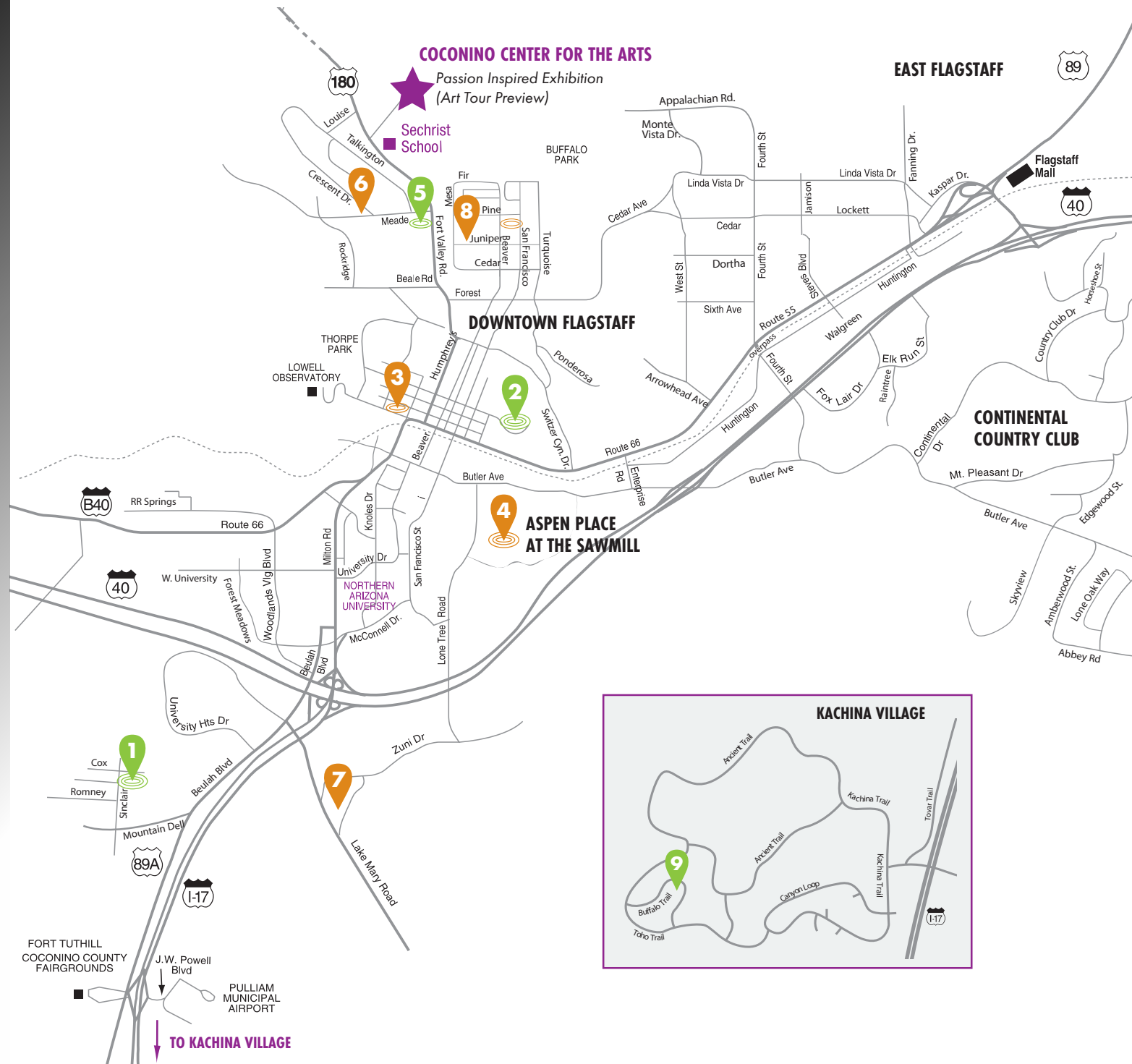

ARTIST LOCATIONS

- 1** **CHRISTINA NORLIN**
Denise Edwards, Joni Pevarnik, Frederica Hall
1255 W. Cox Ave, Mountain Dell
928-699-6824
- 2** **SONDRA FRANCIS**
Pat Kearney, Anita Caro, Cora Salvino
Scott Moore, Sydney Francis
622 E. Cherry Ave
928-779-5885
- 3** **JEREMY ADAIR**
JR MacKenzie
624 W. Aspen Ave
928-853-3531
- 4** **ALAN PETERSEN**
Elaine Dillingham, Jim Schroeder
Comet Gallery at Aspen Place
520 Regent Street
- 5** **SHARON RICHARDS**
Ken Walters
803 W. Meade Ln
928-774-7610
- 6** **DIANE EIDE**
1926 N. Crescent Dr
928-634-8695
- 7** **KEVIN PRATT**
4073 S. Joseph St
720-998-7015
- 8** **GWENDOLYN WARING**
412 W. Juniper Ave
928-226-1126
- 9** **MICHAEL BARBARIC**
3050 E. Buffalo Trail
(Kachina Village)
602-989-2213



MAKE & TAKE DESCRIPTIONS

Pottery

Joni Pevarnik

Try your hand at throwing on the potter's wheel. Make a small piece and have it fired up and glazed. You can make it and pick it up a week later after it has been fired. Clay, assistance with throwing, firing and glazing are included.

Open to all skill levels.
All materials provided. \$20

A Cat In the Hat

Frederica Hall

Join in a fun pleasant time painting and creating hat accessories! Whimsical artistic fun with ball caps and straw hats. Make your own designs or color in ready made ones with the delight of making one of a kind accessories with unique supplies.

Cost: Hats \$10 - \$25
Accessories \$5

MAP
LOCATION
1

Glamorous Glass

Pat Kearney, Sondra Francis, Anita Caro & Cora Salvino

Learn to make shimmering suncatchers, pendants and Christmas Ornaments using glass fusing techniques to take home tomorrow.

Open to all skill levels. All materials provided. \$10

MAP
LOCATION
2

Mini Fabric Piece

Sharon Richards

Come and make a mini fabric piece to be framed or used in making a card later. You may choose to make an abstract piece of art or a realistic scene. Children 5 and up are welcome as long as there is an adult with them to supervise as an iron will be used.

MAP
LOCATION
5

Recycling Nature Through ART

Michael Barbaric

Get a piece of wood and make something from it, change it, sculpt it, show your art in the wood. Open area for paints/colors/brushes and wood carving/cutting tools. Open area full of wood from the forest to choose your masterpiece. Please also contribute to an in process art figure sculpture. **No Fee.**

MAP
LOCATION
9